

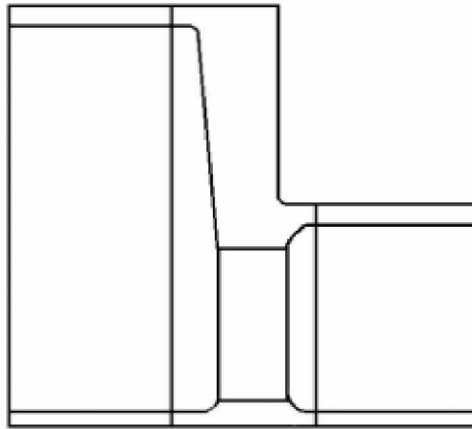

INDEPENDENT PIPE PRODUCTS

IPS or DIPS Eccentric Reducer
Pressure rating will vary depending on specification



Many gravity flow and drainage pipeline require a uniform line and grade. To achieve this, the engineer and designer specify eccentric reducer. This keeps the pipe invert at the same level or slope along the pipeline length.

Based on the permutation and combination of possible diameters, eccentric reducers are quoted for each inquiry or project. These fittings are quite popular for gravity flow sewer with multiple lateral sewer inlet or outlet.